

NOTES

1. DO NOT SCALE FROM THIS DRAWING.
2. THIS DRAWING SHALL BE READ IN CONJUNCTION WITH THE OTHER DRAWINGS INCLUDED IN THIS SERIES.
3. LOCATION OF ALL BURIED SERVICES TO BE CONFIRMED PRIOR TO CONSTRUCTION.
3. ALL DIMENSIONS ARE IN METERS, UNLESS OTHERWISE STATED.
4. ALL CHAINAGES ARE IN KILOMETERS.
5. DRAWING TO BE PRINTED IN COLOUR.
6. ALL LEVELS ARE IN METERS ABOVE ORDNANCE DATUM (MOD) UNLESS OTHERWISE STATED.
7. THE DART+ COASTAL NORTH PROJECT IS POSITIONED ACCORDING TO THE IRISH TRANSVERSE MERCATOR (ITM) COORDINATE SYSTEM.
8. EXISTING TROUGHING TO BE REMOVED POST CONSTRUCTION OF PROPOSED TROUGHING.
9. SELECTED INFRASTRUCTURE INTERVENTIONS DRIVING THE LINESIDE CIVILS DESIGN SUCH AS SUBSTATIONS HAVE BEEN SHOWN FOR INFORMATION ON THESE LINEAR WORKS PLANS. FOR A FULL PICTURE OF ALL INTERVENTIONS ACROSS THE PROJECT, PLEASE REFER TO THE BOOK 1 RAILWAY WORKS PLANS.
10. OHLE STRUCTURES ARE SHOWN AT INDICATIVE LOCATIONS AT A SPACING OF TYPICALLY 40m TO 50m. OHLE WIRES WILL SPAN BETWEEN THE STRUCTURES.

LEGEND

- DEVELOPMENT BOUNDARY
- EXISTING ELEMENTS
- ELEMENTS TO BE REMOVED
- PROPOSED UNDER TRACK CROSSING (UTX)
- PROPOSED TROUGHING
- PROPOSED ELEVATED TROUGHING
- PROPOSED FENCING
- CABLE DUCTS IN PLATFORM
- PROPOSED OVERHEAD LINE EQUIPMENT
- TRACKWORK (EXISTING AND PROPOSED)
- PLATFORM MODIFICATIONS
- PROPOSED SIGNAL
- PROPOSED LOCATION CASE

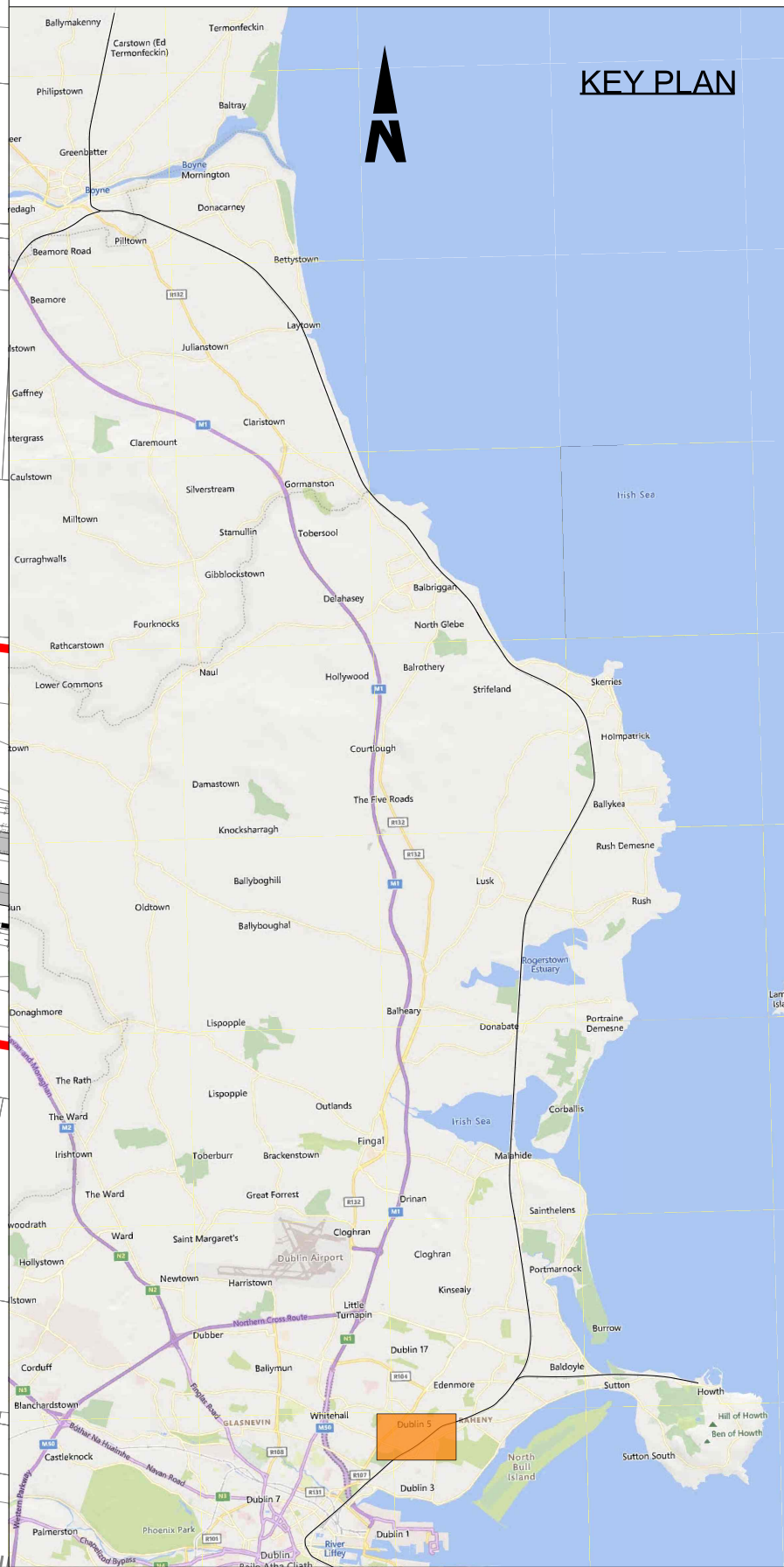

Disclaimer

© Irish Rail (2023). This drawing is confidential and the copyright in it is owned by Irish Rail. This drawing must not be either loaned, copied or otherwise reproduced in whole or in part or used for any purpose without the prior permission of Irish Rail.

© OpenStreetMap contributors

© Ordnance Survey Ireland and Government of Ireland. All O.S. data used for plans are printed under Copyright Ordnance Survey Ireland 0039723 (OSi Aerial Data or OSi Lidar Data) & 2023/OSi_NMA_100 (OSi Vector Data). All elevations are in metres and relate to OSi Geoid Height (OSGM02). Main Heat is defined by existing Project Control. All Co-ordinates are in Irish Transverse Mercator Grid (ITM) as defined by OSi active GPS station Tallaght College (TLTG).



Rev	Date	Dm	Chk'd	App'd	Description
P01	12/04/2024	AC	EJ	DB	PLANNING ISSUE



Date	01/06/2023	Scale	1:500 at A1 1:1000 at A3	Drawn	AC	Checked	EJ	Approved	DB
Project Code	D+WP56	Originator Code	ARP	OMS Code	280275-00				

Scale: 1:500
Paper Size: 1261mm x 594mm

Project Title	DART+ COASTAL NORTH		
Drawing Title	LINEAR WORKS		
Drawing File Name	D+WP56-ARP-P4-NL-DR-RO-100004	Sheet Number	4 of 58
Status	S3	Rev	P01

DO NOT SCALE USE FIGURED DIMENSIONS ONLY

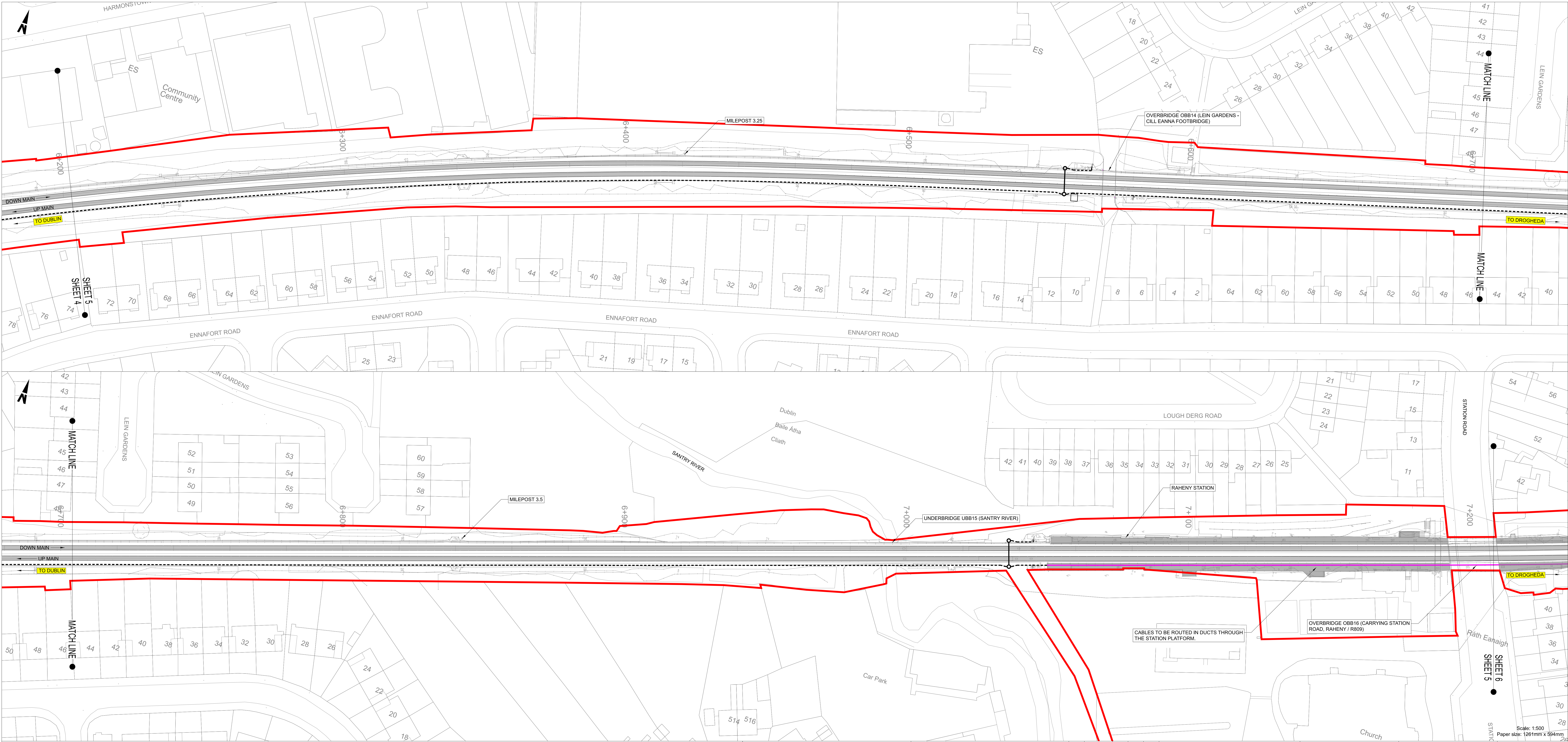

NOTES

1. DO NOT SCALE FROM THIS DRAWING.
2. THIS DRAWING SHALL BE READ IN CONJUNCTION WITH THE OTHER DRAWINGS INCLUDED IN THIS SERIES.
3. LOCATION OF ALL BURIED SERVICES TO BE CONFIRMED PRIOR TO CONSTRUCTION.
3. ALL DIMENSIONS ARE IN METERS, UNLESS OTHERWISE STATED.
4. ALL CHAINAGES ARE IN KILOMETERS.
5. DRAWING TO BE PRINTED IN COLOUR.
6. ALL LEVELS ARE IN METERS ABOVE ORDNANCE DATUM (MOD) UNLESS OTHERWISE STATED.
7. THE DART+ COASTAL NORTH PROJECT IS POSITIONED ACCORDING TO THE IRISH TRANSVERSE MERCATOR (ITM) COORDINATE SYSTEM.
8. EXISTING TROUGHING TO BE REMOVED POST CONSTRUCTION OF PROPOSED TROUGHING.
9. SELECTED INFRASTRUCTURE INTERVENTIONS DRIVING THE LINESIDE CIVILS DESIGN SUCH AS SUBSTATIONS HAVE BEEN SHOWN FOR INFORMATION ON THESE LINEAR WORKS PLANS. FOR A FULL PICTURE OF ALL INTERVENTIONS ACROSS THE PROJECT, PLEASE REFER TO THE BOOK 1 RAILWAY WORKS PLANS.
10. OHLE STRUCTURES ARE SHOWN AT INDICATIVE LOCATIONS AT A SPACING OF TYPICALLY 40m TO 50m. OHLE WIRES WILL SPAN BETWEEN THE STRUCTURES.

LEGEND

- DEVELOPMENT BOUNDARY
- EXISTING ELEMENTS
- ELEMENTS TO BE REMOVED
- PROPOSED UNDER TRACK CROSSING (UTX)
- PROPOSED TROUGHING
- PROPOSED ELEVATED TROUGHING
- PROPOSED FENCING
- CABLE DUCTS IN PLATFORM
- PROPOSED OVERHEAD LINE EQUIPMENT
- TRACKWORK (EXISTING AND PROPOSED)
- PLATFORM MODIFICATIONS
- PROPOSED SIGNAL
- PROPOSED LOCATION CASE

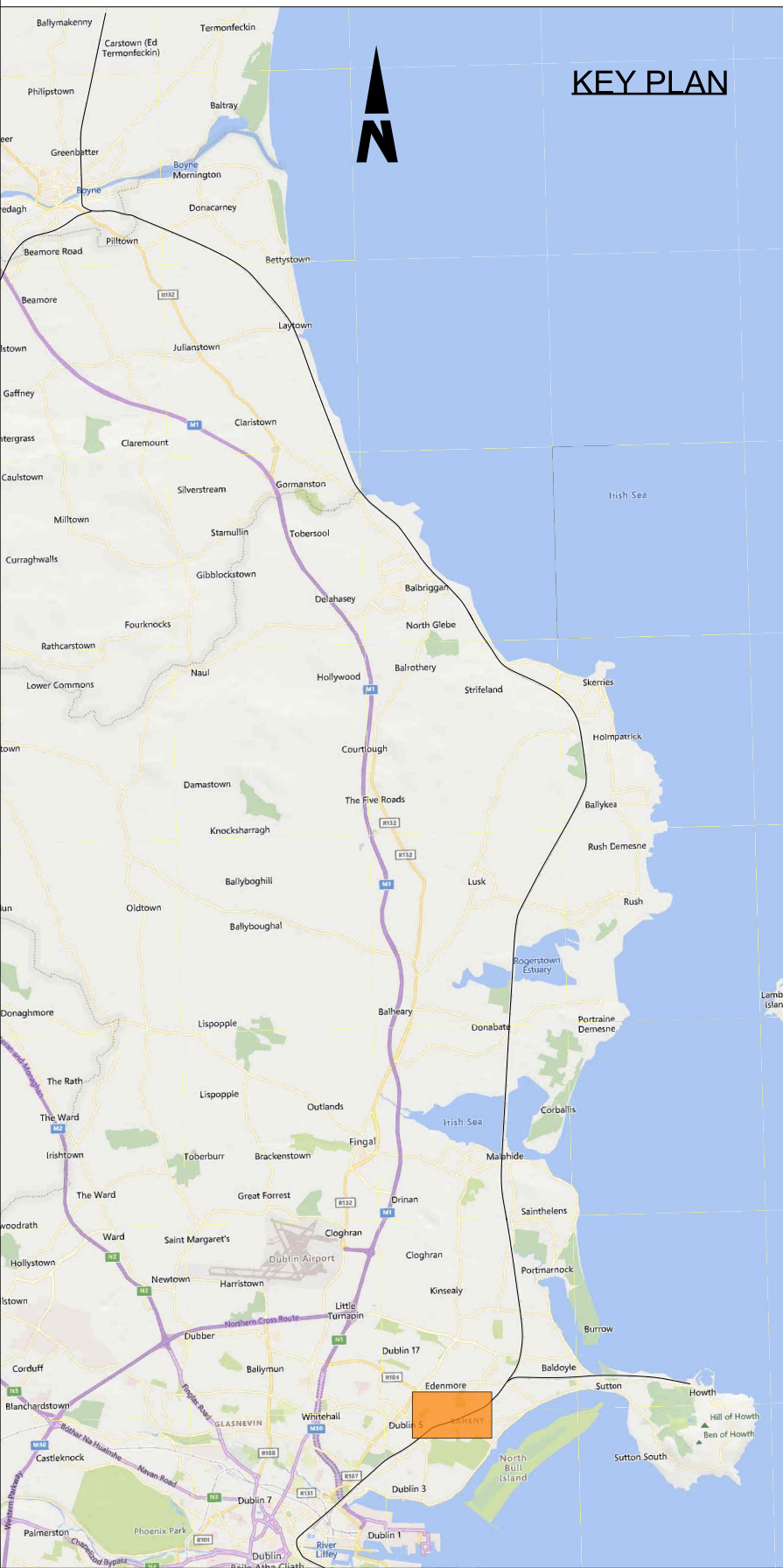

Disclaimer
© Irish Rail (2023). This drawing is confidential and the copyright in it is owned by Irish Rail. This drawing must not be either loaned, copied or otherwise reproduced in whole or in part or used for any purpose without the prior permission of Irish Rail.
© OpenStreetMap contributors
© Ordnance Survey Ireland and Government of Ireland. All O.S. data used for plans are printed under Copyright Ordnance Survey Ireland 0039723 (OSi Aerial Data or OSi Lidar Data) & 2023 OSi, NMA, 180 (OSi Vector Data). All elevations are in metres and relate to OSi Geoid Model (OSGM02). Main Heat is defined by existing Project Control. All Co-ordinates are in Irish Transverse Mercator Grid (ITM) as defined by OSi active GPS station Tallaght College (TLTG).



Rev	Date	Dm	Chk'd	App'd	Description
P01	12/04/2024	AC	EJ	DB	PLANNING ISSUE



Date	Scale	Drawn	Checked	Approved
01/06/2023	As shown	AC	EJ	DB
Project Code	Originator Code	QMS Code	280275-00	
D+WP56	ARP			

Project Title	Drawing Title	Drawing File Name	Sheet Number	Status	Rev
DART+ COASTAL NORTH	LINEAR WORKS	D+WP56-ARP-P4-NL-DR-RO-100005	5 of 58	S3	P01

DO NOT SCALE USE FIGURED DIMENSIONS ONLY

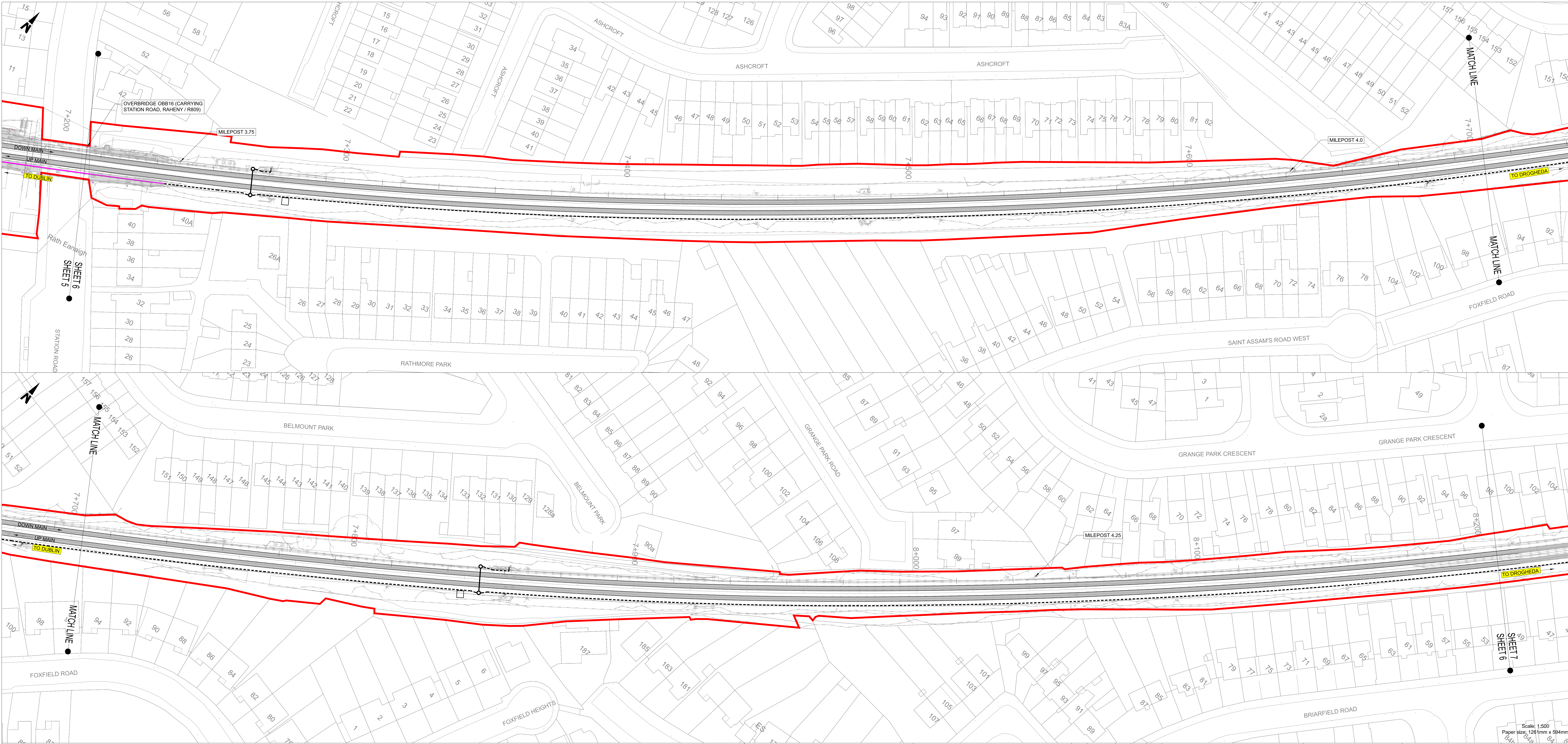

NOTES

1. DO NOT SCALE FROM THIS DRAWING.
2. THIS DRAWING SHALL BE READ IN CONJUNCTION WITH THE OTHER DRAWINGS INCLUDED IN THIS SERIES.
3. LOCATION OF ALL BURIED SERVICES TO BE CONFIRMED PRIOR TO CONSTRUCTION.
3. ALL DIMENSIONS ARE IN METERS, UNLESS OTHERWISE STATED.
4. ALL CHAINAGES ARE IN KILOMETERS.
5. DRAWING TO BE PRINTED IN COLOUR.
6. ALL LEVELS ARE IN METERS ABOVE ORDNANCE DATUM (MOD) UNLESS OTHERWISE STATED.
7. THE DART+ COASTAL NORTH PROJECT IS POSITIONED ACCORDING TO THE IRISH TRANSVERSE MERCATOR (ITM) COORDINATE SYSTEM.
8. EXISTING TROUGHING TO BE REMOVED POST CONSTRUCTION OF PROPOSED TROUGHING.
9. SELECTED INFRASTRUCTURE INTERVENTIONS DRIVING THE LINESIDE CIVILS DESIGN SUCH AS SUBSTATIONS HAVE BEEN SHOWN FOR INFORMATION ON THESE LINEAR WORKS PLANS. FOR A FULL PICTURE OF ALL INTERVENTIONS ACROSS THE PROJECT, PLEASE REFER TO THE BOOK 1 RAILWAY WORKS PLANS.
10. OHLE STRUCTURES ARE SHOWN AT INDICATIVE LOCATIONS AT A SPACING OF TYPICALLY 40m TO 50m. OHLE WIRES WILL SPAN BETWEEN THE STRUCTURES.

LEGEND

- DEVELOPMENT BOUNDARY
- EXISTING ELEMENTS
- ELEMENTS TO BE REMOVED
- PROPOSED UNDER TRACK CROSSING (UTX)
- - - PROPOSED TROUGHING
- - - PROPOSED ELEVATED TROUGHING
- - - PROPOSED FENCING
- CABLE DUCTS IN PLATFORM
- PROPOSED OVERHEAD LINE EQUIPMENT
- TRACKWORK (EXISTING AND PROPOSED)
- PLATFORM MODIFICATIONS
- PROPOSED SIGNAL
- PROPOSED LOCATION CASE

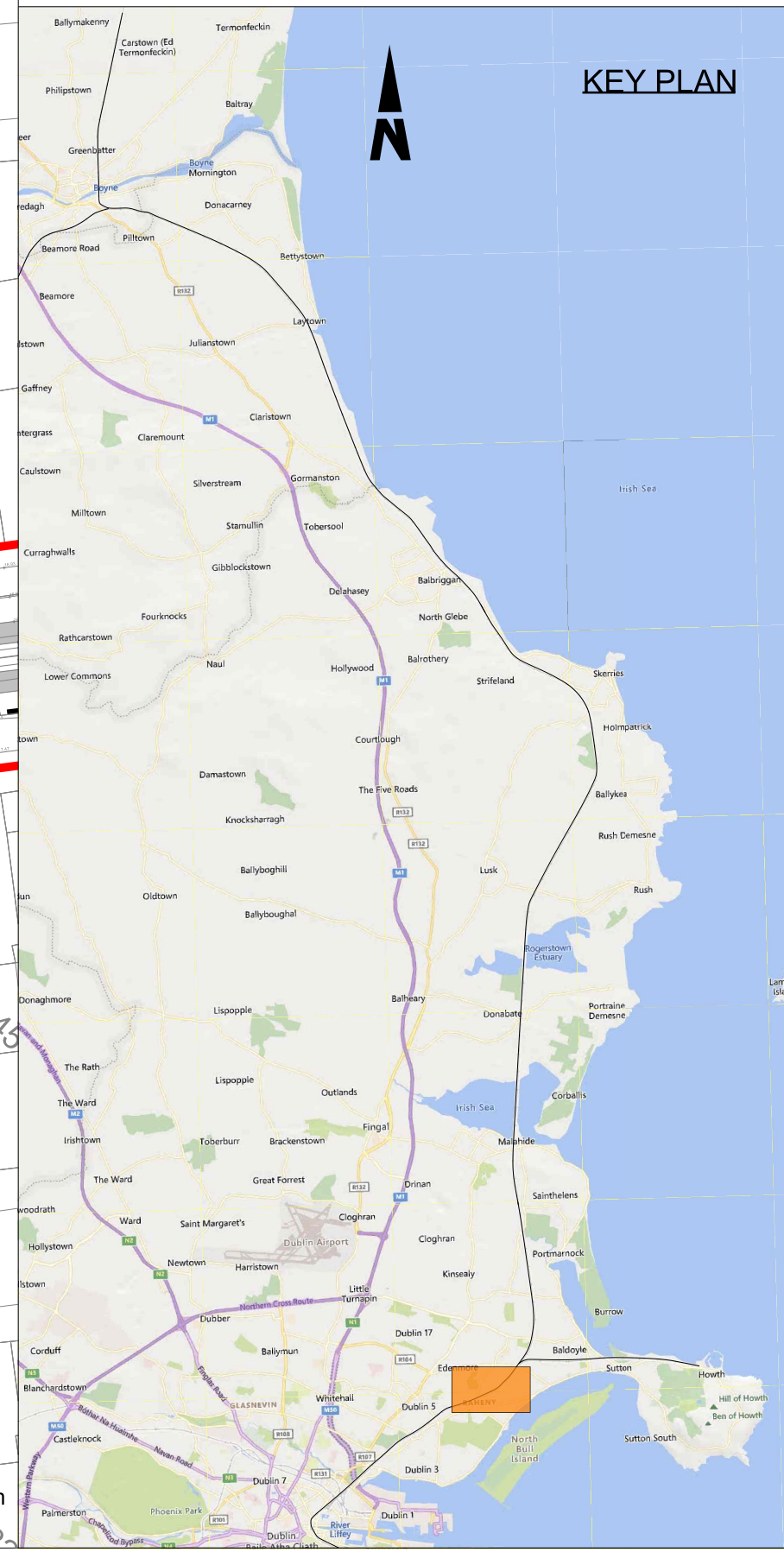

Disclaimer

© Irish Rail (2023). This drawing is confidential and the copyright in it is owned by Irish Rail. This drawing must not be either loaned, copied or otherwise reproduced in whole or in part or used for any purpose without the prior permission of Irish Rail.

© OpenStreetMap contributors

© Ordnance Survey Ireland and Government of Ireland. All O.S. data used for plans are printed under Copyright Ordnance Survey Ireland 0039723 (OSi Aerial Data or OSi Lidar Data) & 2023 OSi, NMA, 180 (OSi Vector Data). All elevations are in metres and relate to OSi Geoid Model (OSGM02). Main Head is defined by existing Project Control. All Co-ordinates are in Irish Transverse Mercator Grid (ITM) as defined by OSi active GPS station Tallaght College (TLTG).

Rev	Date	Dm	Chk'd	App'd	Description
P01	12/04/2024	AC	EJ	DB	PLANNING ISSUE

larnród Éireann
Irish Rail

Engineering Designer

Date	Scale	Drawn	Checked	Approved
01/06/2023	As shown	AC	EJ	DB

Project Code	Originator Code	OMS Code	280275-00
D+WP56	ARP		

Client

Project Title

Drawing Title

Drawing File Name

Sheet Number

Status

Rev

6 of 58

S3

P01

DO NOT SCALE USE FIGURED DIMENSIONS ONLY

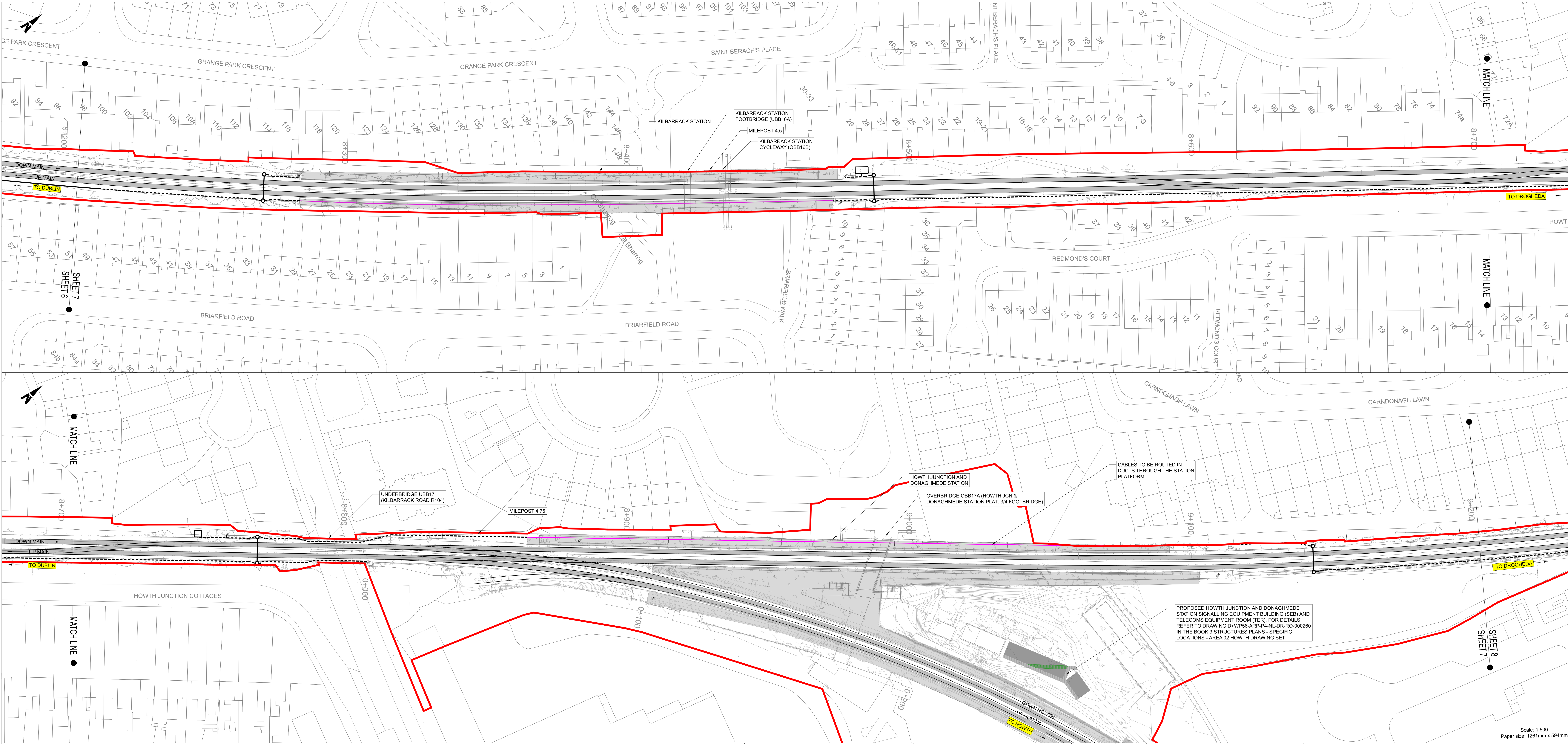

- NOTES**
1. DO NOT SCALE FROM THIS DRAWING.
 2. THIS DRAWING SHALL BE READ IN CONJUNCTION WITH THE OTHER DRAWINGS INCLUDED IN THIS SERIES.
 3. LOCATION OF ALL BURIED SERVICES TO BE CONFIRMED PRIOR TO CONSTRUCTION.
 3. ALL DIMENSIONS ARE IN METERS, UNLESS OTHERWISE STATED.
 4. ALL CHAINAGES ARE IN KILOMETERS.
 5. DRAWING TO BE PRINTED IN COLOUR.
 6. ALL LEVELS ARE IN METERS ABOVE ORDNANCE DATUM (MOD) UNLESS OTHERWISE STATED.
 7. THE DART+ COASTAL NORTH PROJECT IS POSITIONED ACCORDING TO THE IRISH TRANSVERSE MERCATOR (ITM) COORDINATE SYSTEM.
 8. EXISTING TROUGHING TO BE REMOVED POST CONSTRUCTION OF PROPOSED TROUGHING.
 9. SELECTED INFRASTRUCTURE INTERVENTIONS DRIVING THE LINESIDE CIVILS DESIGN SUCH AS SUBSTATIONS HAVE BEEN SHOWN FOR INFORMATION ON THESE LINEAR WORKS PLANS. FOR A FULL PICTURE OF ALL INTERVENTIONS ACROSS THE PROJECT, PLEASE REFER TO THE BOOK 1 RAILWAY WORKS PLANS.
 10. OHLE STRUCTURES ARE SHOWN AT INDICATIVE LOCATIONS AT A SPACING OF TYPICALLY 40m TO 50m. OHLE WIRES WILL SPAN BETWEEN THE STRUCTURES.

- LEGEND**
- DEVELOPMENT BOUNDARY
 - EXISTING ELEMENTS
 - ELEMENTS TO BE REMOVED
 - PROPOSED UNDER TRACK CROSSING (UTC)
 - PROPOSED TROUGHING
 - PROPOSED ELEVATED TROUGHING
 - PROPOSED FENCING
 - CABLE DUCTS IN PLATFORM
 - PROPOSED OVERHEAD LINE EQUIPMENT
 - TRACKWORK (EXISTING AND PROPOSED)
 - PLATFORM MODIFICATIONS
 - PROPOSED SIGNAL
 - PROPOSED LOCATION CASE

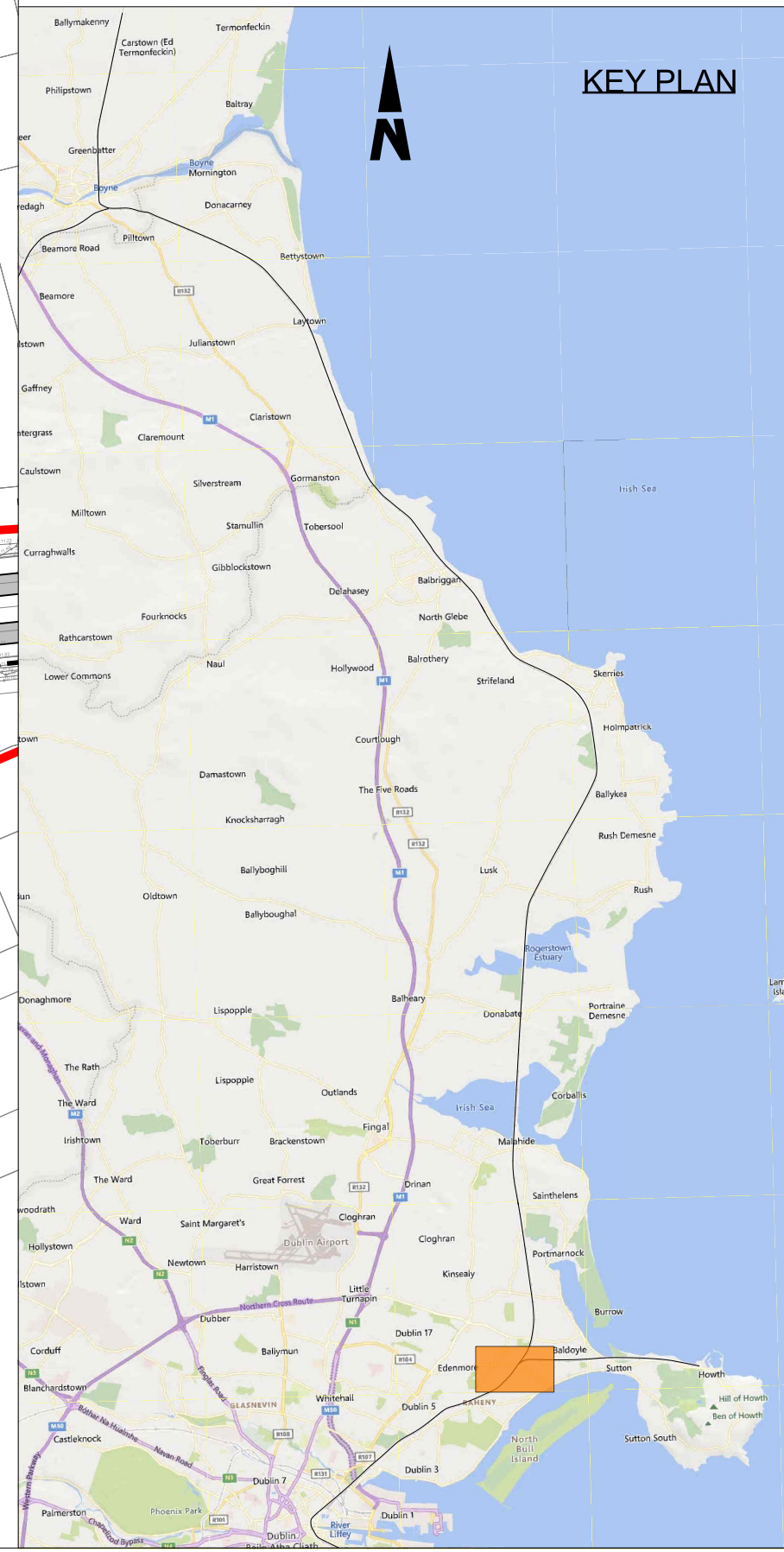

Disclaimer

© Irish Rail (2023). This drawing is confidential and the copyright in it is owned by Irish Rail. This drawing must not be either loaned, copied or otherwise reproduced in whole or in part or used for any purpose without the prior permission of Irish Rail.

© OpenStreetMap contributors

© Ordnance Survey Ireland and Government of Ireland. All O.S. data used for plans are printed under Copyright Ordnance Survey Ireland 003723 (OSI Aerial Data or OSI Lidar Data) & 2023/OSI, NMA, 180 (OSI Vector Data). All elevations are in metres and relate to OSI Geoid Model (OSGM02). Main Head is defined by existing Project Control. All Co-ordinates are in Irish Transverse Mercator Grid (ITM) as defined by OSI active GPS station Tallaght College (TLTG).

Notes

1. For continuation see drawing D+WP56-ARP-P4-NL-DR-RO-100053

Rev	Date	Dm	Chk'd	App'd	Description
P01	12/04/2024	AC	EJ	DB	PLANNING ISSUE

Client

larnród Éireann
Irish Rail

Engineering Designer

ARUP

Project Title

DART+ COASTAL NORTH

Drawing Title

Linear Works

Date	Scale	Drawn	Checked	Approved
01/06/2023	As shown	AC	EJ	DB

Project Code

D+WP56

Originator Code

ARP

OMS Code

280275-00

Drawing File Name

D+WP56-ARP-P4-NL-DR-RO-100007

Sheet Number	Status	Rev
7 of 58	S3	P01

DO NOT SCALE USE FIGURED DIMENSIONS ONLY